

UNIT, DIRECT SUPPORT, AND GENERAL SUPPORT MAINTENANCE
REPAIR PARTS AND SPECIAL TOOLS LIST

EXTENDED SERVICE PROGRAM (ESP)

TRUCK, CARGO, 2-1/2-TON, 6X6, M44A3 SERIES TRUCKS (DIESEL)

M35A3, W/O WINCH (NSN 2320-01-383-2047); W/WINCH (NSN 2320-01-383-3850);
M35A3C, W/O WINCH (NSN 2320-01-383-2050); W/WINCH (NSN 2320-01-383-2049);
M36A3, W/O WINCH (NSN 2320-01-383-2048); W/WINCH (NSN 2320-01-383-2046).

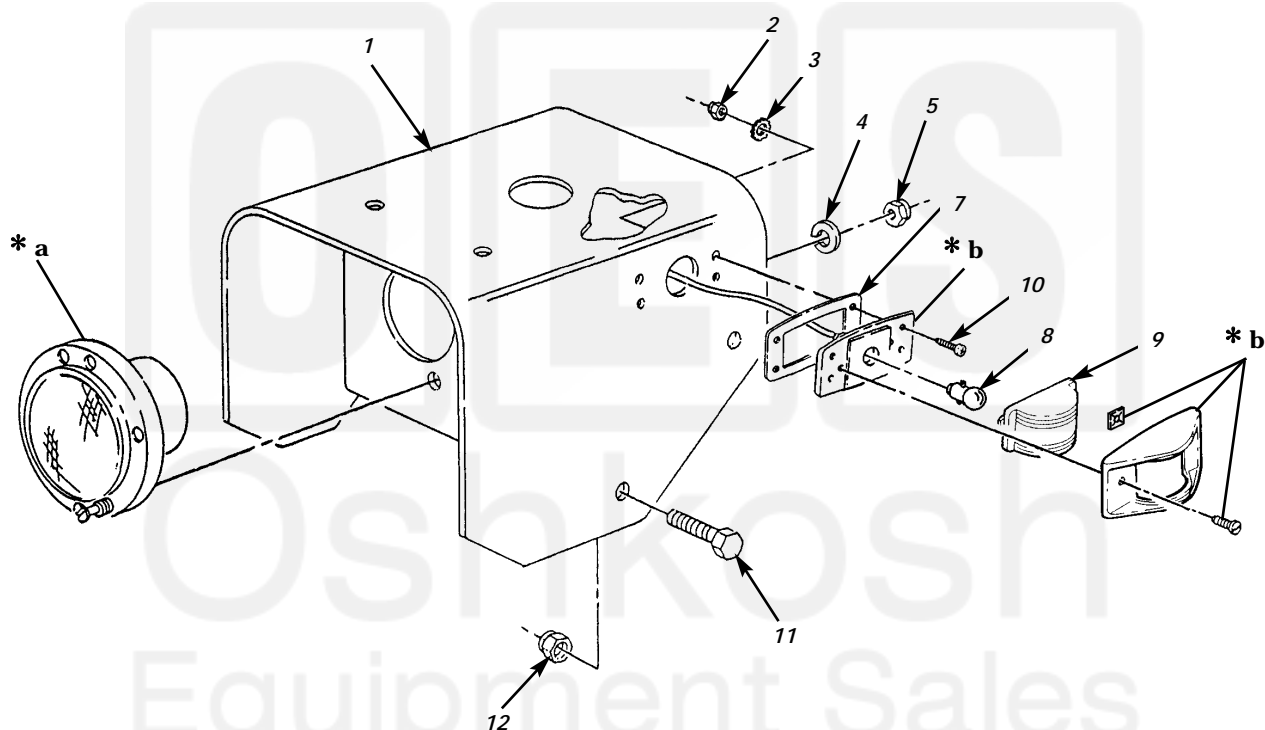
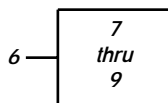

* a FOR BREAKDOWN SEE TM 9-2320-361-20P

* b PART OF ITEM 6

Figure 59. Headlamp, Front Side Marker, and Mounting Bracket.

(1) ITEM NO	(2) SMR CODE	(3) NSN	TM9-2320-386-24P (4) CAGEC	(5) PART NUMBER	(6) DESCRIPTION AND USABLE ON CODES(UOC)	0060 00 (7) QTY
GROUP 0609 LIGHTS						
FIG. 59 HEADLAMP, FRONT SIDE MARKER, AND MOUNTING BRACKET						
1	PAZZ	5340014076225	19207	12448988	BRACKET, MOUNTING L.H.....	1
1	PAZZ	5340014076230	19207	12448989	BRACKET, MOUNTING R.H.....	1
2	PAZZ	5310002514503	24617	9411893	NUT, LOCK.....	8
3	PAZZ	5310008892769	96906	MS45904-61	WASHER, LOCK.....	2
4	PAZZ	5310005825965	96906	MS35338-44	WASHER, LOCK.....	6
5	PAZZ	5310007680319	96906	MS51968-2	NUT, PLAIN, HEXAGON.....	6
6	PAOO	6220005773434	96906	MS35423-1	LIGHT, MARKER, CLEAR.....	2
7	PAZZ	5330003530959	73331	5939841	. FELT, MECHANICAL, PRE.....	1
8	PAZZ	6240000190877	46717	LA-361-9	. LAMP, INCANDESCENT.....	1
9	PAZZ	6220002997425	96906	MS35421-1	. LENS, LIGHT.....	1
10	PAZZ	5305011858647	11862	160057	SCREW, MACHINE.....	8
11	PAZZ	5305011409118	80204	B1821BH038C088N	SCREW, CAP, HEXAGON H.....	8
12	PAZZ	5310004582382	24617	9418969	NUT, SELF-LOCKING, HE.....	8

END OF FIGURE

